

Temporary Traffic Control For 1st Responders

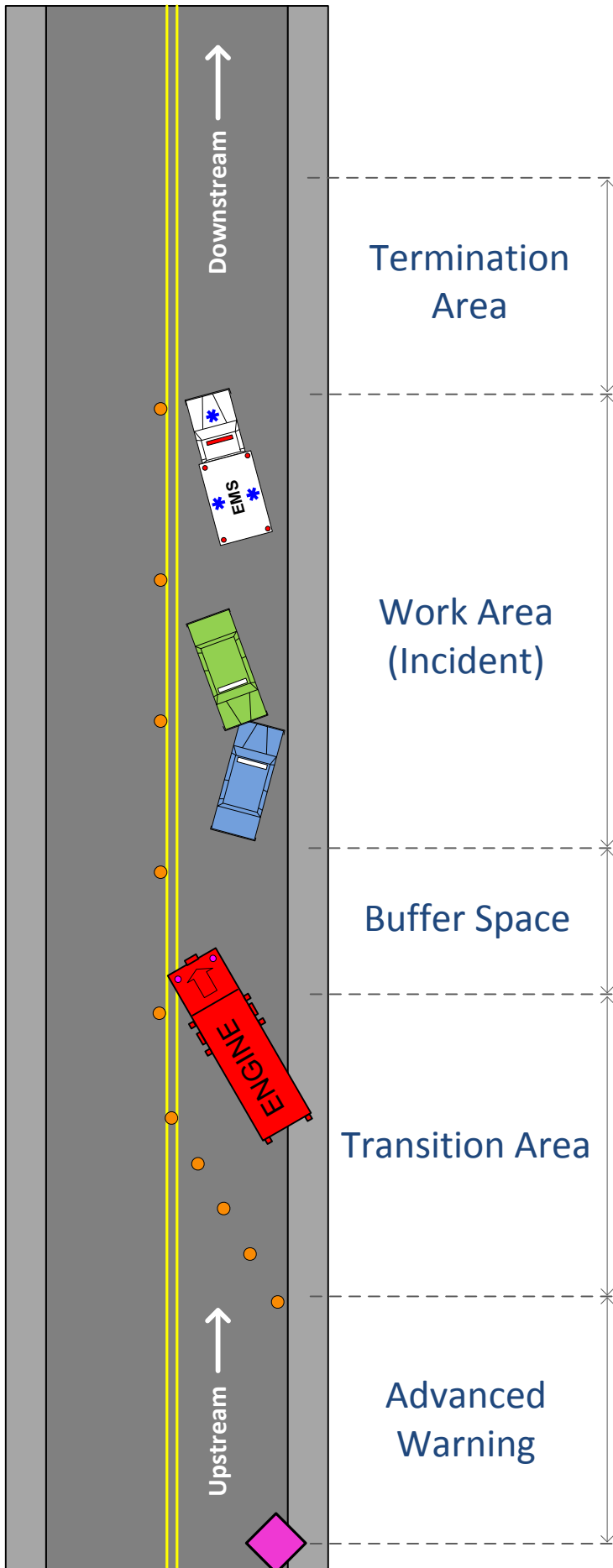

Advanced Warning



Estimated Stopping Distances

Speed	Distance (feet)
25 mph	155
35 mph	250
40 mph	305
45 mph	360
50 mph	425
55 mph	495
65 mph	645
70 mph	730

Advanced Warning

Road Type	Distance
Urban (low speed)	100 feet
Urban (high speed)	350 feet
Rural	500 feet
Highway	1000 feet

Estimating Distances

Distance between utility poles

Approx. 75 ft to 100 ft

Roadway skip lines

Line = 10 ft

break = 30 ft

Normal pace (step)

Approx. 3 ft

Example

Distance from Transition to Advanced Warning sign on a rural roadway with a typical speed of 50 mph:

Stopping dist = 425 ft Adv Warning = 500 ft

5 to 6 pole sections

12 skip lines

165 paces